



CoreloT



Your antenna design partner

CoreloT mmWave 24_31GHz Antenna Datasheet



Datasheet

COREIOT MMWAVE 24_31GHZ ANTENNA

Introduction

CoreloT Technologies offers a compact passive mmWave antenna operating from 24-31GHz antenna for Verification antenna for AUT in test & measurement, mmWave Applications.

Electrical Specification

1. Frequency: 24 – 31GHz
2. Impedance: 50 Ω

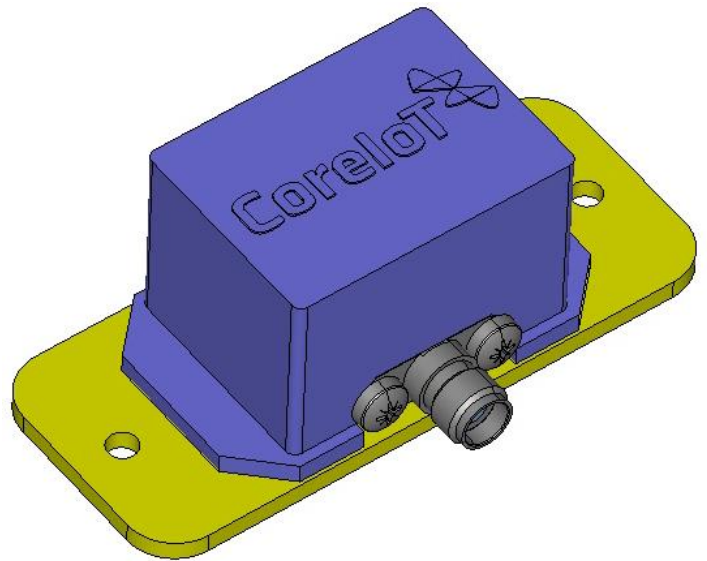

BAND	24-31GHz
Frequency(GHz)	24 – 31
VSWR	< 1.9
Return loss (dB)	< -10
Peak gain(dBi)	12
Efficiency(%)	> 85
Radiation properties	Directional
Max. input power	10W
Polarization	Linear Polarization
Impedence(ohms)	50

COREIOT MMWAVE 24_31GHZ ANTENNA

Features

1. Passive Patch Antenna
2. frequency Band 24-31GHz
3. Size of antenna 30*22*21mm
4. >85% Efficiency
5. 12dBi peak Gain
6. Linear Polarization
7. SMA Connector

Applications

1. Verification antenna for AUT in test & measurement.
2. mmWave Applications

Return Loss

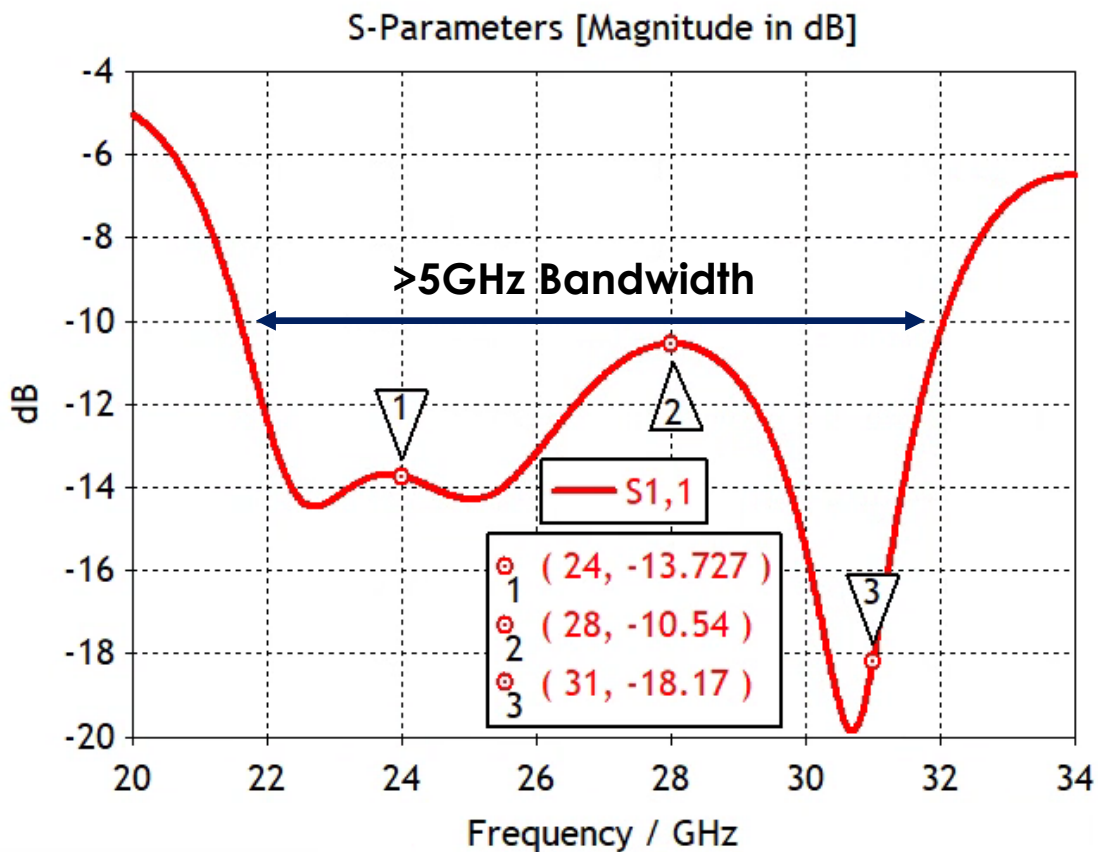

COREIOT MMWAVE 24_31GHZ ANTENNA

Realized Gain and Efficiency

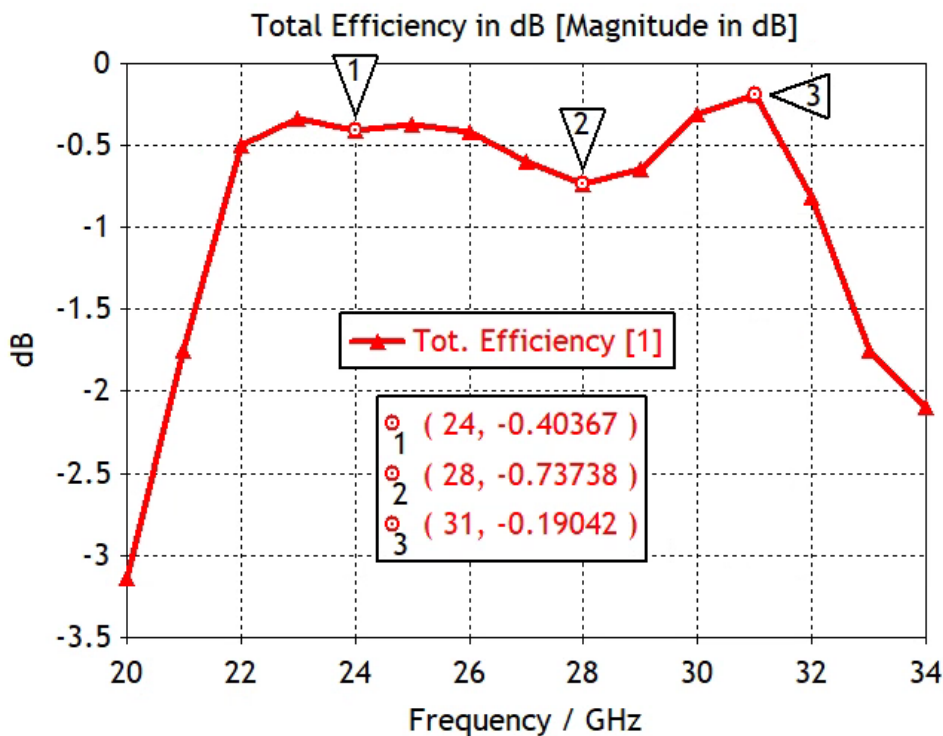
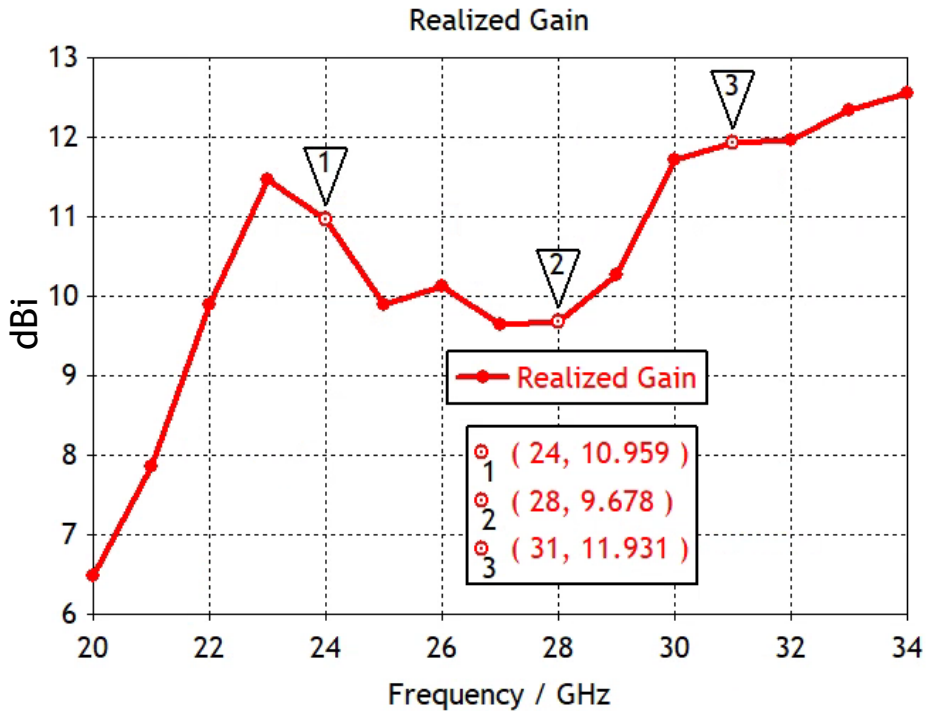

COREIOT MMWAVE 24_31GHZ ANTENNA

Radiation Patterns

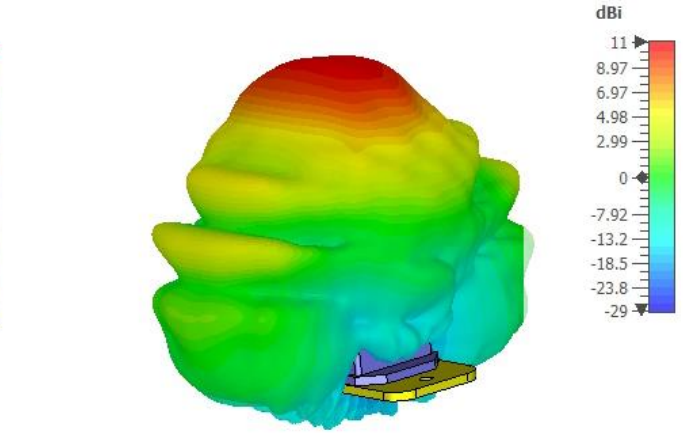
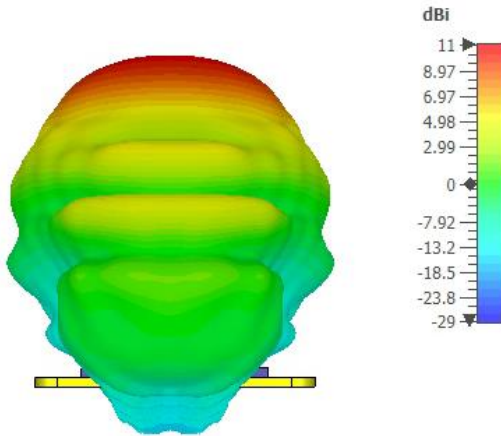

farfield (f=24) [1]

Type	Farfield
Approximation	enabled (...)
Component	Abs
Output	Realized ...
Frequency	24 GHz
Rad. Effic.	-0.08347 ...
Tot. Effic.	-0.4037 dB
Rlzd. Gain	10.96 dBi

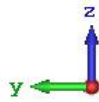

farfield (f=24) [1]

Type	Farfield
Approximation	enabled (...)
Component	Abs
Output	Realized ...
Frequency	24 GHz
Rad. Effic.	-0.08347 ...
Tot. Effic.	-0.4037 dB
Rlzd. Gain	10.96 dBi

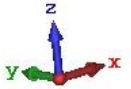

@24GHz

@24GHz

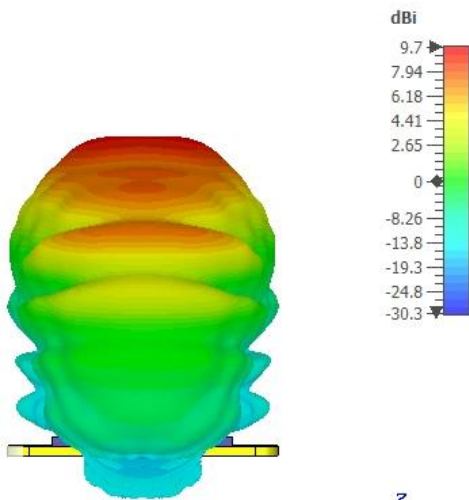

farfield (f=28) [1]

Type	Farfield
Approximation	enabled (...)
Component	Abs
Output	Realized ...
Frequency	28 GHz
Rad. Effic.	-0.08679 ...
Tot. Effic.	-0.7374 dB
Rlzd. Gain	9.705 dBi

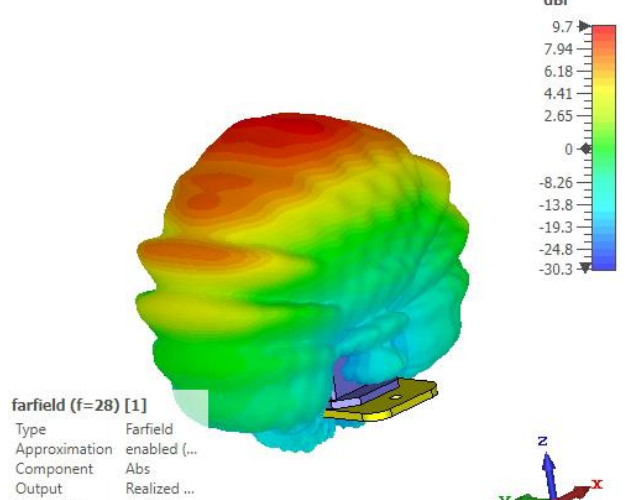

farfield (f=28) [1]

Type	Farfield
Approximation	enabled (...)
Component	Abs
Output	Realized ...
Frequency	28 GHz
Rad. Effic.	-0.08679 ...
Tot. Effic.	-0.7374 dB
Rlzd. Gain	9.705 dBi



@28GHz

@28GHz